

Creating a base using AI

You can create customized bases that suit your workflow with just a simple prompt using Zoho's AI-powered assistant, Zia.

How to create a base using AI

- Navigate to the workspace where you want to create a base.
- In the top-right corner of the bases listing page, you'll see the option to **Create Base with AI**.

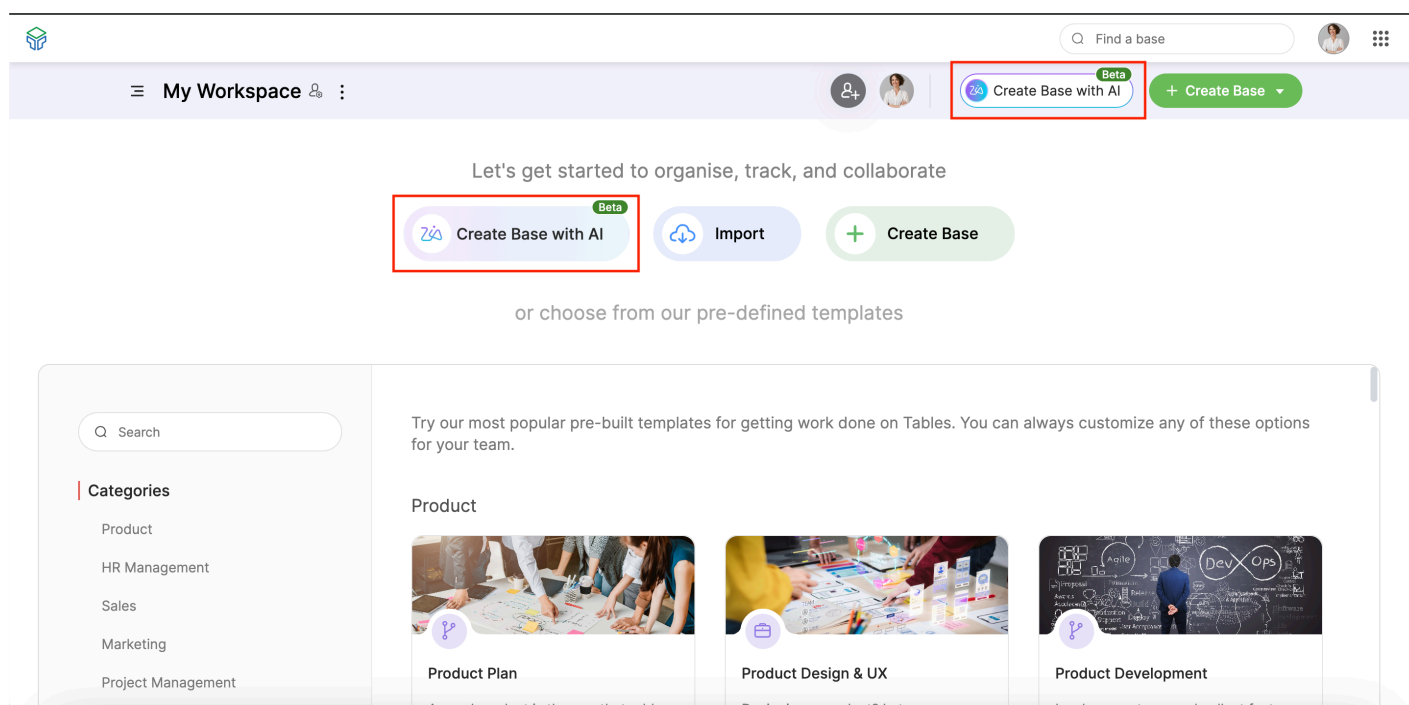

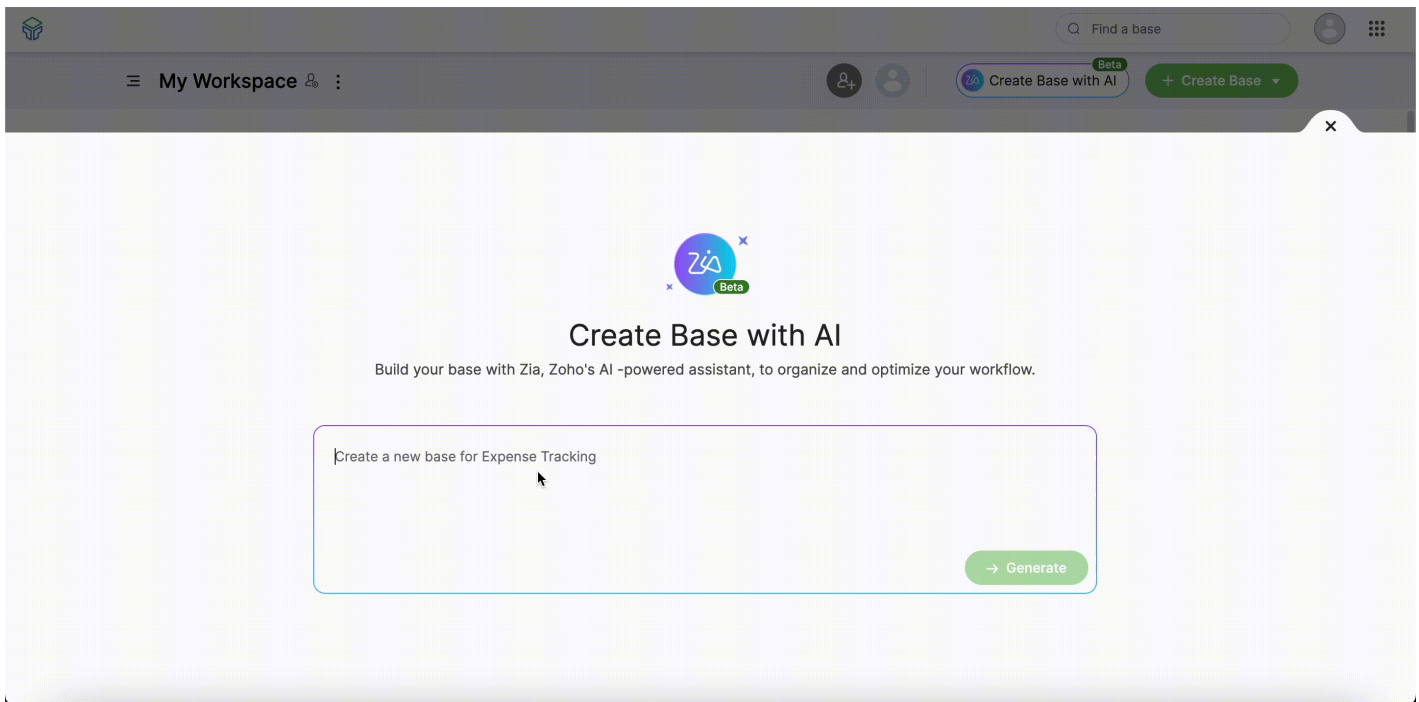

- A pop-up screen will appear where you can enter your prompt and click **Generate**. (Example: "Create a base for competitive analysis of organizations.")
- Zia will then generate different use cases based on the prompt you've provided.

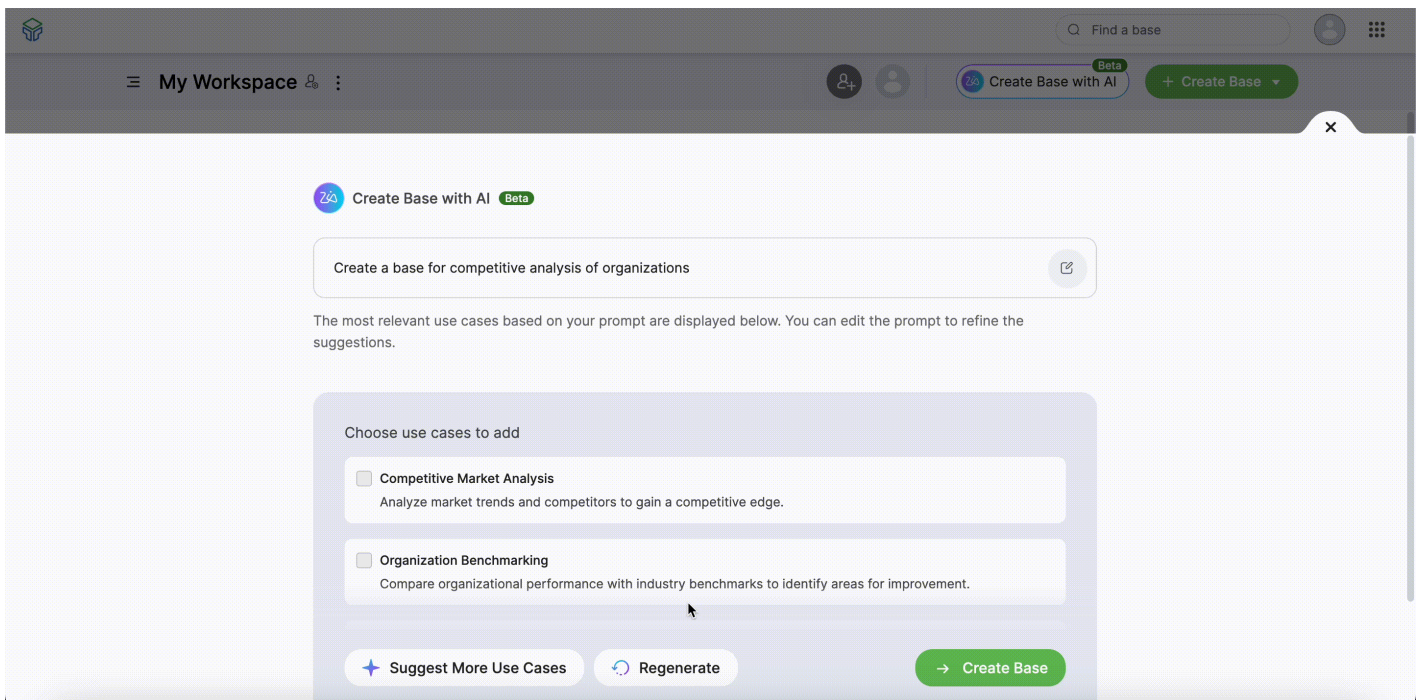

- Choose the use cases that align with your requirement.
- You can also click **Suggest More Use Cases** to get more suggestions, or click **Regenerate** for new use cases.

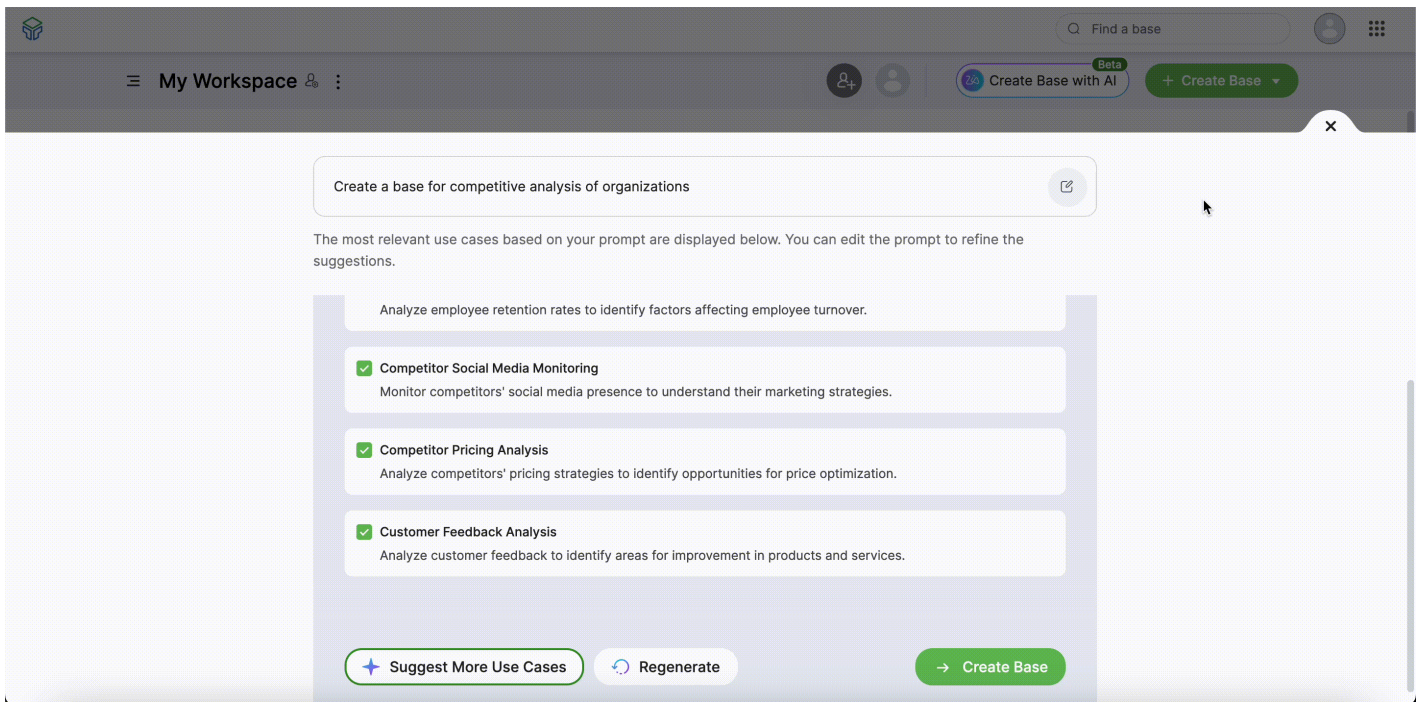



- If the suggestions don't align with your requirements, you can click the edit  icon to refine the prompt and generate new suggestions altogether.
- Once you've chosen your use cases, click **Create Base**, and your base will be created based on the use cases you've chosen.

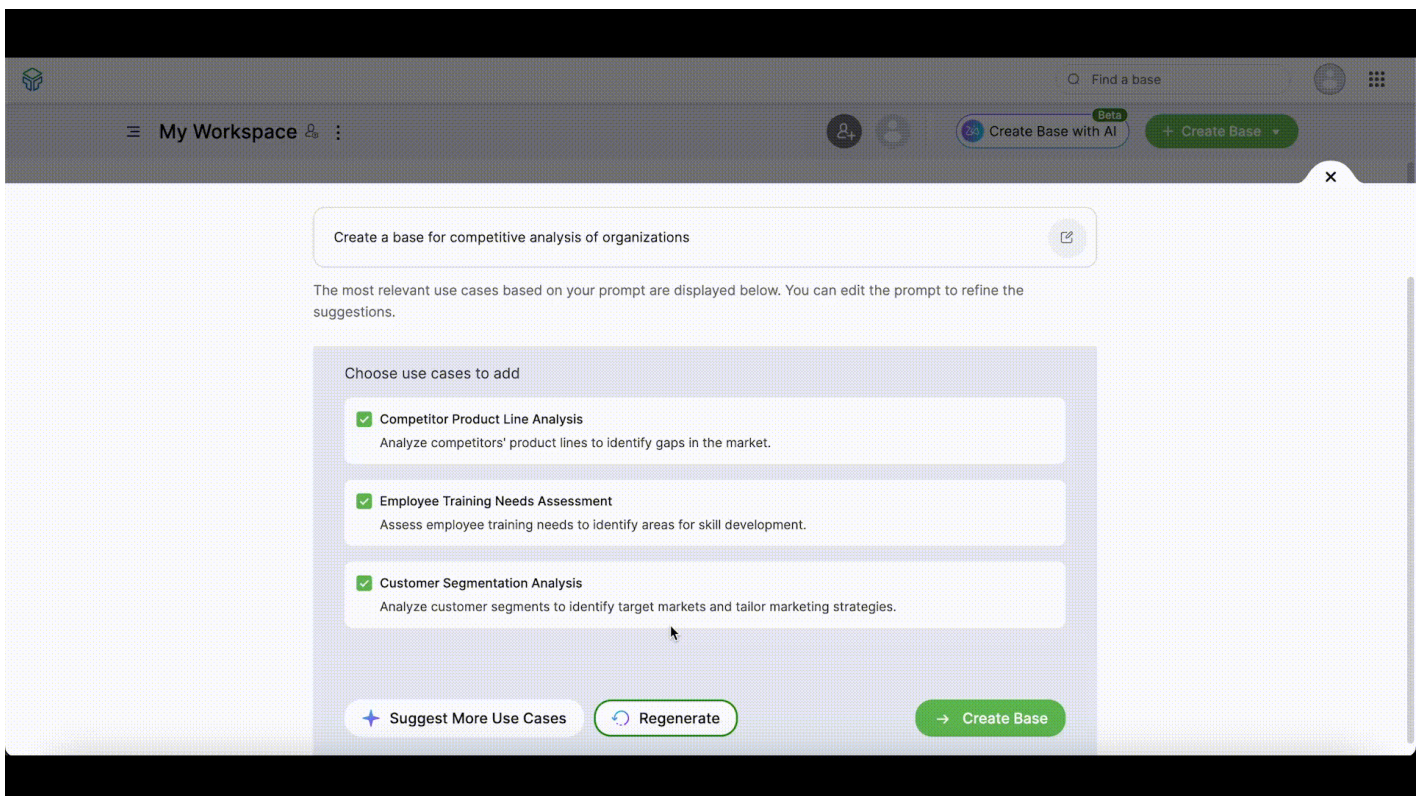

Limitations

- AI can only create your base structure—tables, fields, and field types (excluding formula, collaborator, and AI field types). It won't create views, relationships (link, lookup, or roll up), or automations.
- The prompt should contain fewer than 5,000 characters.
- Use cases are only for reference and verification; they won't determine the number of tables created in a base.